

## STAINLESS STEEL BUTT HINGE

**Code No. S 211**

### APPLICATION

- Suitable for aluminium and timber doors with aluminium, steel and timber frames.

### SPECIFICATION

- **Material:** Stainless Steel **304** Grade.
- **Pin:** 6.9mm - Stainless Steel **304** Grade Punch-Out Pin.
- **Knuckle:** Round
- **Endcaps:** Pressed-in interference fit. Stainless Steel **304** Grade.
- Stamped with McCallum crest.
- Loose Pin.

### INSTALLATION GUIDE ONLY

- **Door thickness: Minimum 30mm.**
- When using a door closer, we recommend a minimum of 4 hinges be used, with the top hinge located as high as possible.
- Standard Door: 2040 (H) x 820 (W) - 3 hinges.

### FIXING

- 32mm x 10g stainless steel fasteners for timber (supplied).
- 12mm x M5 stainless steel metal fasteners (supplied).
- Pop rivets are not recommended.
- Not recommended for Bi-Fold door systems.

### FINISH

- Satin finish.

### OLD CODE NO.

- S10060 SLP

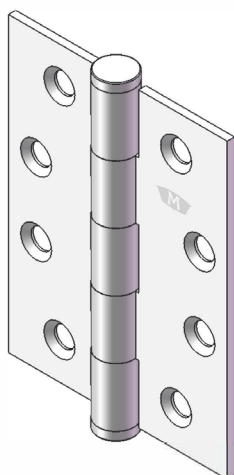
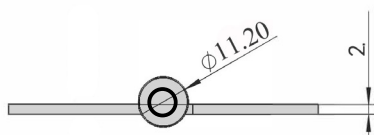
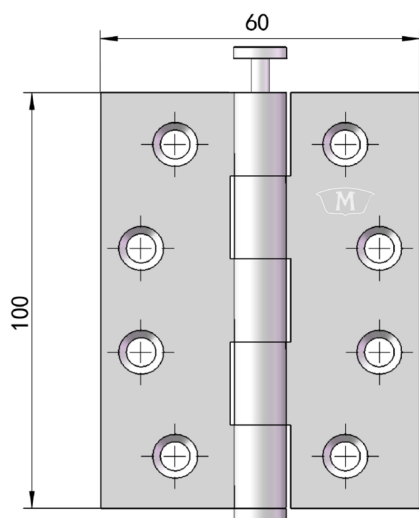

**Code No. S 211**

## RECESS MOUNTED HINGE INFORMATION

### Standard Application:

- The top hinge is 127mm down from the frame rebate to top of the hinge.
- Bottom hinge 254mm from bottom edge of barrel to finished floor.
- The third hinge is centered between the top and bottom hinges (if more than three hinges used, distance is equal for all between the top and bottom hinges.).
- See Example Door A.
- The hinge is to be recessed into the frame door to a depth equal to the thickness of the hinge leaf. This should also be done to the edge of the door to be swung.
- There will be a gap between the frame and the door edge equal to the distance between the two hinges when in the closed position (known as the 'Swage'). See Closed Door Top View diagram.
- Space out and mark all holes for pre-drilling before attaching the hinges.

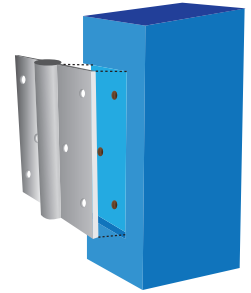

*Recess, Pre-drill and Mount*

### With Door Closer:

- If you are using a door closer, you will need to add an extra hinge on top of the advised chart.
- The spacing between the top two hinges should be the same as the length of the hinge.
- The first hinge should be as close (high) as possible to the door closer. The second should then be spaced equal to the hinge size (length) down the door. All subsequent hinges should be evenly spaced thereafter. See Example Door B.

*Closed Door Top View*

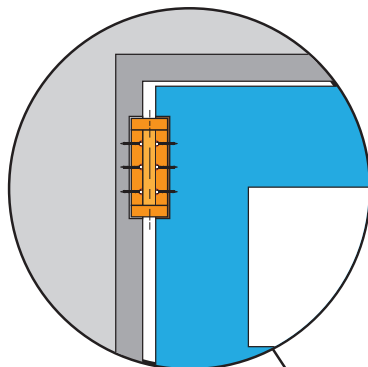
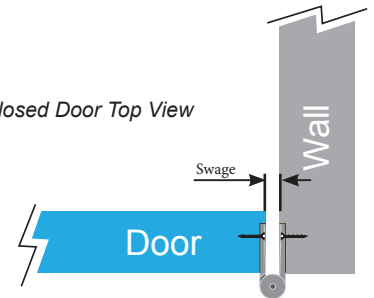

*Mounted View*

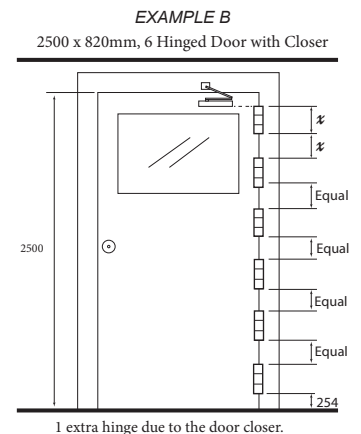
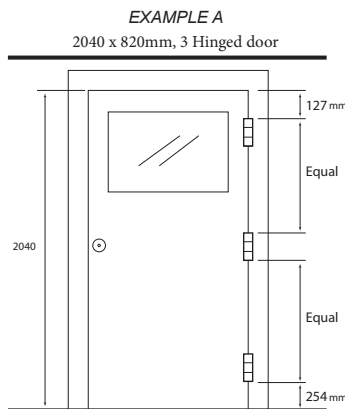

Number of Hinges Required per Door Size	
	820 - 900 mm (W)
2100 mm (H)	3
2300 mm (H)	4
2500 mm (H)	5
*All information is regarded as generic unless specified in writing by us. Contact us for custom sizes and further information.	